

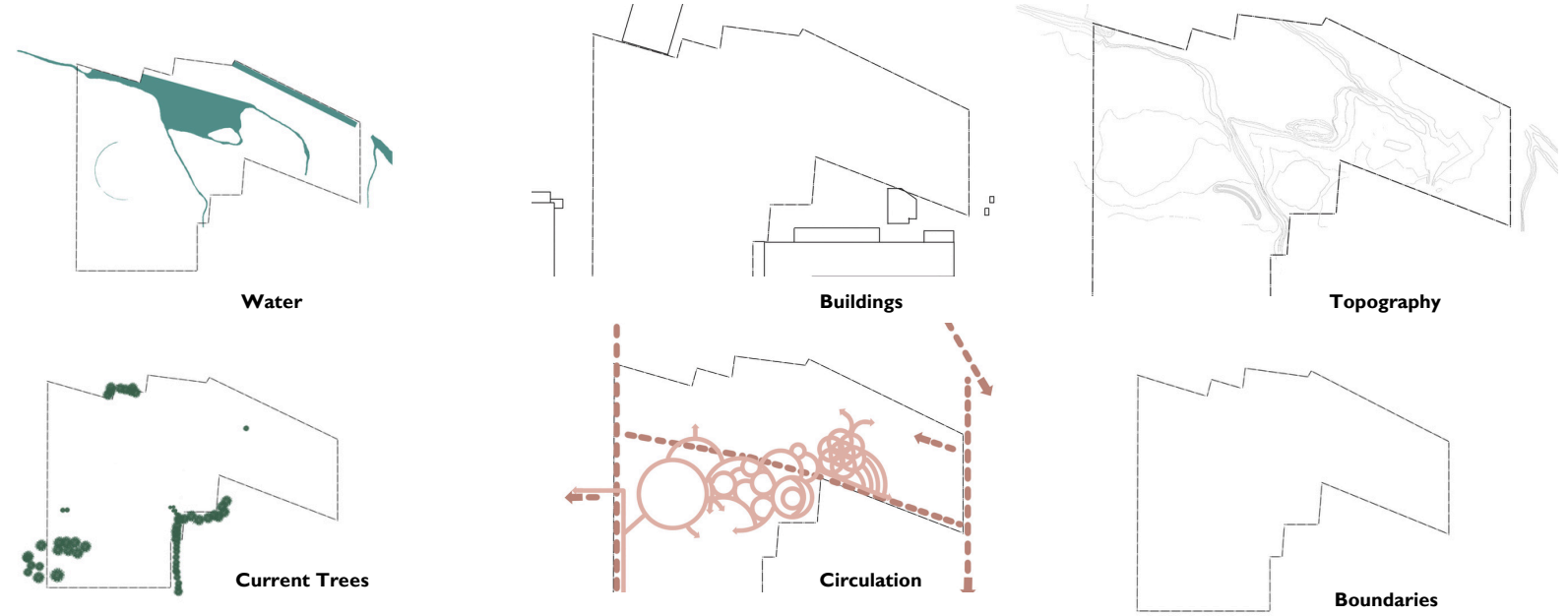

Cultivating a Renaissance in Rural Alabama through Regenerative Farming

Site Conditions



Overview:

The EARTH project, in partnership with ShipShape Urban Farms, is a transformative initiative redefining Alabama's agricultural landscape. By blending regenerative agriculture, advanced farming technologies, community education, and workforce development, the project creates a sustainable model that integrates agriculture with social impact. EARTH serves as a beacon for food security, environmental stewardship, and skill-building, preparing the region for a resilient and food-secure future. With a focus on innovation, heritage, and sustainability, EARTH is setting a new standard for community-centered agricultural development.

A Brief History:

Sylacauga, Alabama, often referred to as "The Marble City," is a town rich in history, natural beauty, and cultural heritage. From its origins as a vital Native American settlement to its modern-day contributions to art, agriculture, and industry, Sylacauga reflects the resilience and ingenuity of its people. While embracing a sustainable future, the city remains deeply connected to its storied past.

The Native American Legacy:

Before European settlers arrived, Sylacauga was home to the Creek Nation, thriving along the fertile banks of the Coosa River. The region also featured ceremonial mounds constructed by earlier cultures, symbolizing community and spiritual connection to the land. These mounds inspire aspects of the EARTH project's design, honoring the area's heritage.

The name Sylacauga itself is derived from the Creek words "Chalauke," meaning "Cherokee," and "oka," meaning "place." This reflects its role as a meeting ground and crossroads for Native American tribes long before it became a modern settlement.

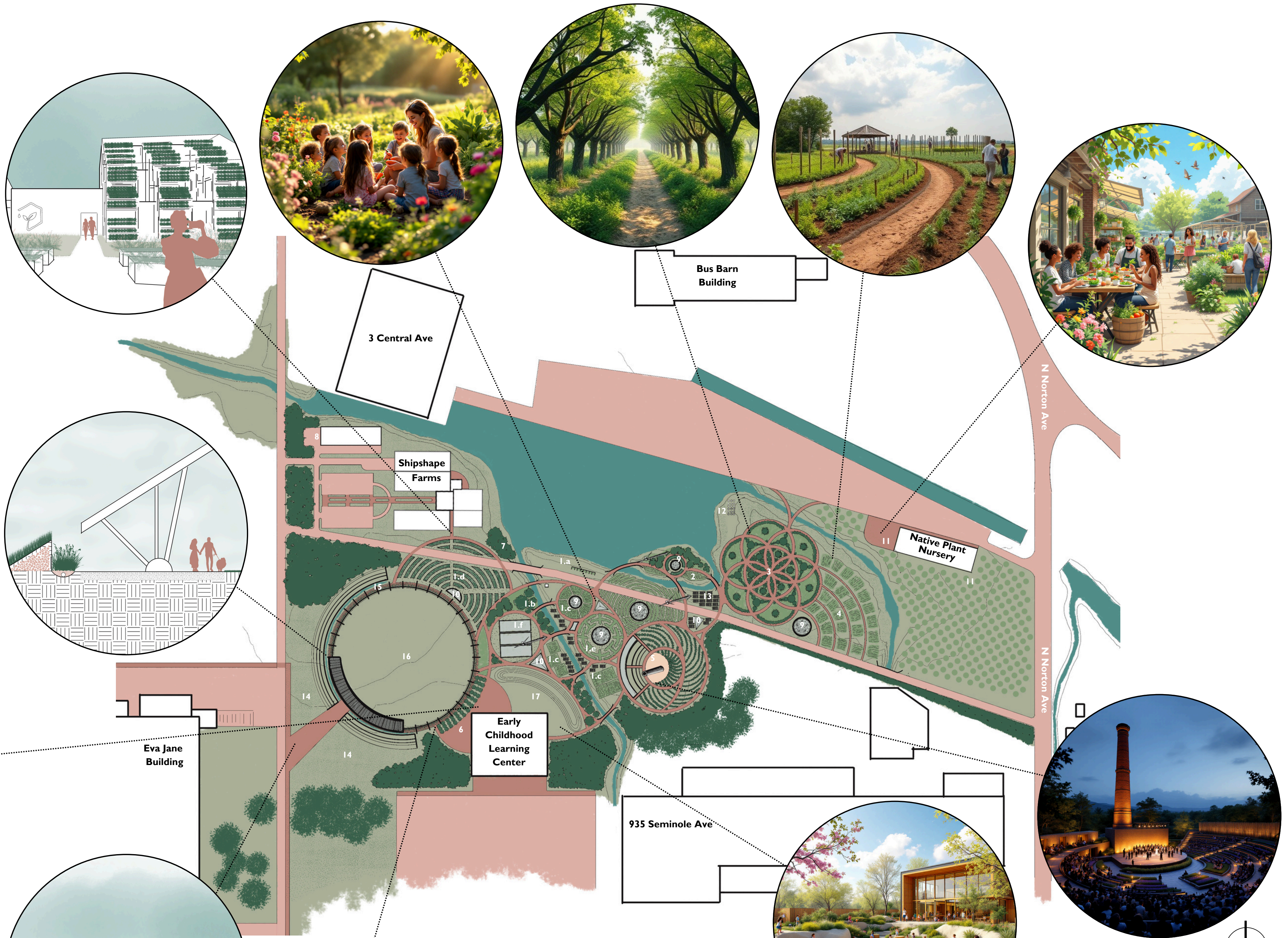

Project Elements

- George Washington Carver Regenerative Showcase Garden: Features:**
 - a. Composting and soil health areas.
 - b. A small food forest with layered planting.
 - c. Well-watered gardens (20x20 plots) for simple, low-maintenance cultivation.
 - d. Raised beds for seasonal crops.
 - e. A labyrinth garden promoting biodiversity with hollies and blueberries.
 - f. Hoop houses and greenhouses to extend the growing season.
- Island Garden:**
 - Uses Hugelkultur mounds for soil health and resilience, also acting as a windbreak.
- Large Food Forest:**
 - Designed with sacred geometry, curvilinear paths, and perennial crops for ecological diversity.
- Well-Watered Gardens:**
 - Traditional 20x20 plots for community use and low-tech farming practices.
- Amphitheater Garden:**
 - A spiral garden with aromatic plants like lavender and rosemary, offering a striking amphitheater view.
- Kitchen Garden:**
 - Supplies fresh produce for meals, farm-to-table events, and culinary education near the Early Childhood Center.
- Bamboo Screen & Vista:**
 - Bamboo plantings frame the lawn, with a vista showcasing a wire outline of Avondale Mill to honor its history.
- Barn and Large Equipment Shed:**
 - A Quonset hut for tools, seed distribution, and crop processing.
- Geodesic Dome Greenhouses:**
 - Optimizes space for propagation and seedling growth with innovative greenhouse designs.
- Outdoor Classrooms:**
 - Open-air spaces in gardens for workshops and education.
- Nursery and Farm-to-Table Café:**
 - Features a nursery for plants and a café serving seasonal dishes from the farm.
- Bee Hives and Equipment:**
 - Promotes pollination and honey production.
- Renewable Energy Systems:**
 - Solar, wind, and renewable systems sustainably power operations.
- Pollinator Gardens:**
 - Native flowering plants ensure a thriving ecosystem for pollinators.
- Art Trail**
 - Marble sculptures and pathways narrate the site's history and cultural legacy.
- One-Acre Lawn:**
 - Versatile space for events, fundraisers, and gatherings.
- Nature-Based Playground:**
 - Sustainable play structures, water features, and sensory gardens for environmental education.

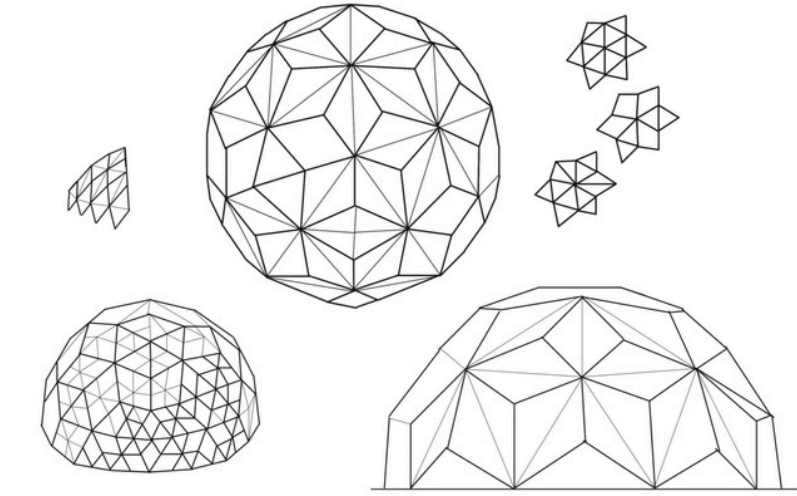
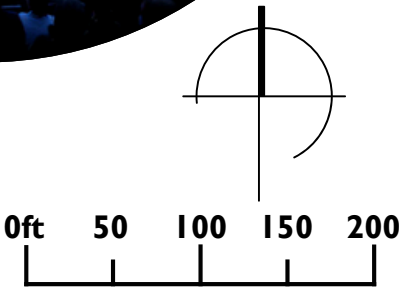

Geodesic Dome Greenhouses

Today, Sylacauga's people are crafting a future that honors their storied past while embracing environmental stewardship and technological advancement. From preserving natural resources to adopting forward-thinking initiatives, the city's residents embody a commitment to sustainability and adaptability. These efforts ensure Sylacauga remains a beacon of possibility, showing how communities can thrive by balancing heritage with progress.

From its celebrated quarries to new agricultural frontiers, Sylacauga epitomizes the spirit of transformation.

The EARTH project exemplifies this vision, transforming Sylacauga's natural resources, cultural legacy, and community spirit into a foundation for sustainable growth. By merging regenerative agriculture, renewable energy, and community engagement, EARTH reinforces Sylacauga's reputation as a marble capital and a pioneer in sustainable development. This initiative highlights the city's commitment to creating a future that is both impactful and enduring, reflecting its unwavering dedication to innovation, sustainability, and community connection.

The EARTH project honors this rich history by incorporating quilt-patterned hardscapes inspired by Alabama's celebrated quilting tradition. These intricate designs pay homage to the artistry and cultural significance of quilting, which embodies themes of community, creativity, and resourcefulness. Just as quilting stitches together disparate pieces to form something greater, these hardscapes reflect Sylacauga's enduring ability to adapt, innovate, and flourish.

By blending the past with a vision for the future, the EARTH project reimagines Sylacauga's legacy as a model for sustainable development and creative transformation. It stands as a testament to the town's spirit of reinvention, turning historical inspiration into a vibrant foundation for community growth and environmental stewardship.

In partnership with ShipShape Urban Farms, the EARTH project integrates renewable energy systems and advanced agricultural technologies to create meaningful employment opportunities, attract innovative industries, and strengthen the local economy. By leveraging Sylacauga's rich resources and heritage, EARTH is transforming the community into a model for sustainable development.

Sylacauga Today and Tomorrow

Sylacauga seamlessly blends small-town charm with significant opportunities, evolving from its historic marble quarries to its emerging role as a leader in sustainable agriculture. Known as "The Marble City," Sylacauga has long been celebrated for its world-renowned white marble, which has shaped landmarks and works of art across the nation. The marble's unmatched quality and timeless beauty stand as a testament to the city's legacy of craftsmanship and ingenuity, forming the backbone of a community rooted in resourcefulness and resilience. This spirit of excellence extends beyond marble, shaping Sylacauga's journey through generations of innovation and progress.

A New Era: Sustainability and Regenerative Growth

Sylacauga is now at the forefront of sustainable development, skillfully balancing economic growth with environmental stewardship. Projects like the EARTH Regenerative Agriculture Project exemplify this vision, combining Controlled Environment Agriculture (CEA) with regenerative farming practices to enhance food security, workforce development, and environmental sustainability. These initiatives not only connect to Sylacauga's agricultural roots but also redefine its role in shaping a greener, more resilient future.

The Marble Capital:

Sylacauga's identity transformed in the early 19th century with the discovery of pure white marble, among the world's finest, rivaling Italy's Carrara marble. Quarrying began in the 1830s, and by the 20th century, Sylacauga became a leading supplier of marble for monuments, buildings, and sculptures nationwide.

The EARTH project incorporates Sylacauga White Marble into pathways and sculptures, celebrating the city's unique natural resource while supporting local industries. This integration connects the past to the present, highlighting the enduring value of Sylacauga's marble.

The Textile Industry and Industrial Growth

In the late 19th and early 20th centuries, Sylacauga evolved into a hub for textile production, with mills such as Avondale Mills serving as economic and social cornerstones. These mills not only provided jobs but also shaped the community, supported local schools, churches, and recreational programs. The textile industry became deeply woven into the fabric of Sylacauga's identity, creating a legacy of craftsmanship that defined the town for generations.